

# Technical Data servo motor 1,2 Nm/3 Nm/9 Nm

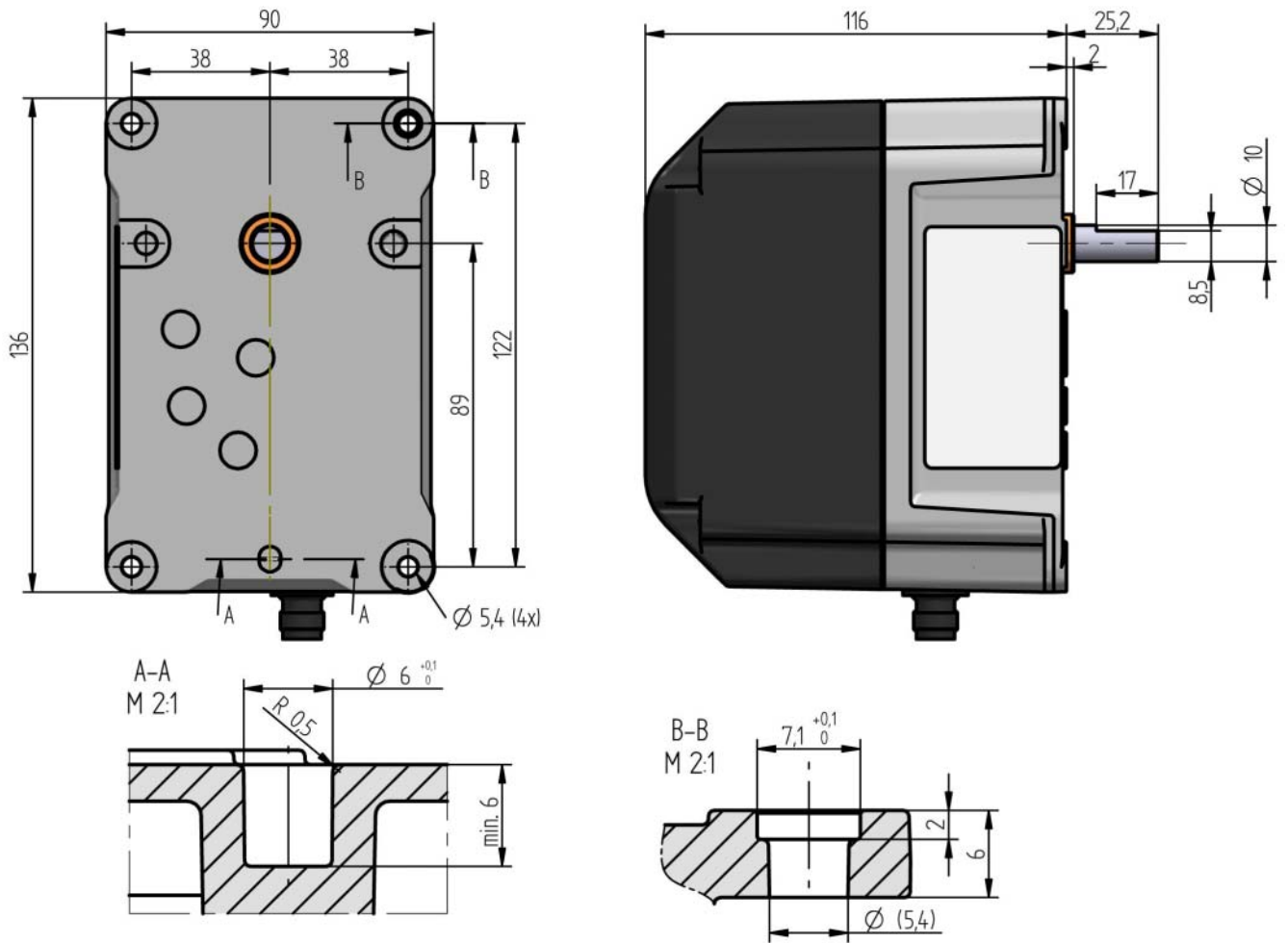

Fig. 1-1 Dimensional drawing of servo motor type 662R5001-0 and 662R5003-0 without cable but with plug

# Technical Data servo motor 1,2 Nm/3 Nm/9 Nm

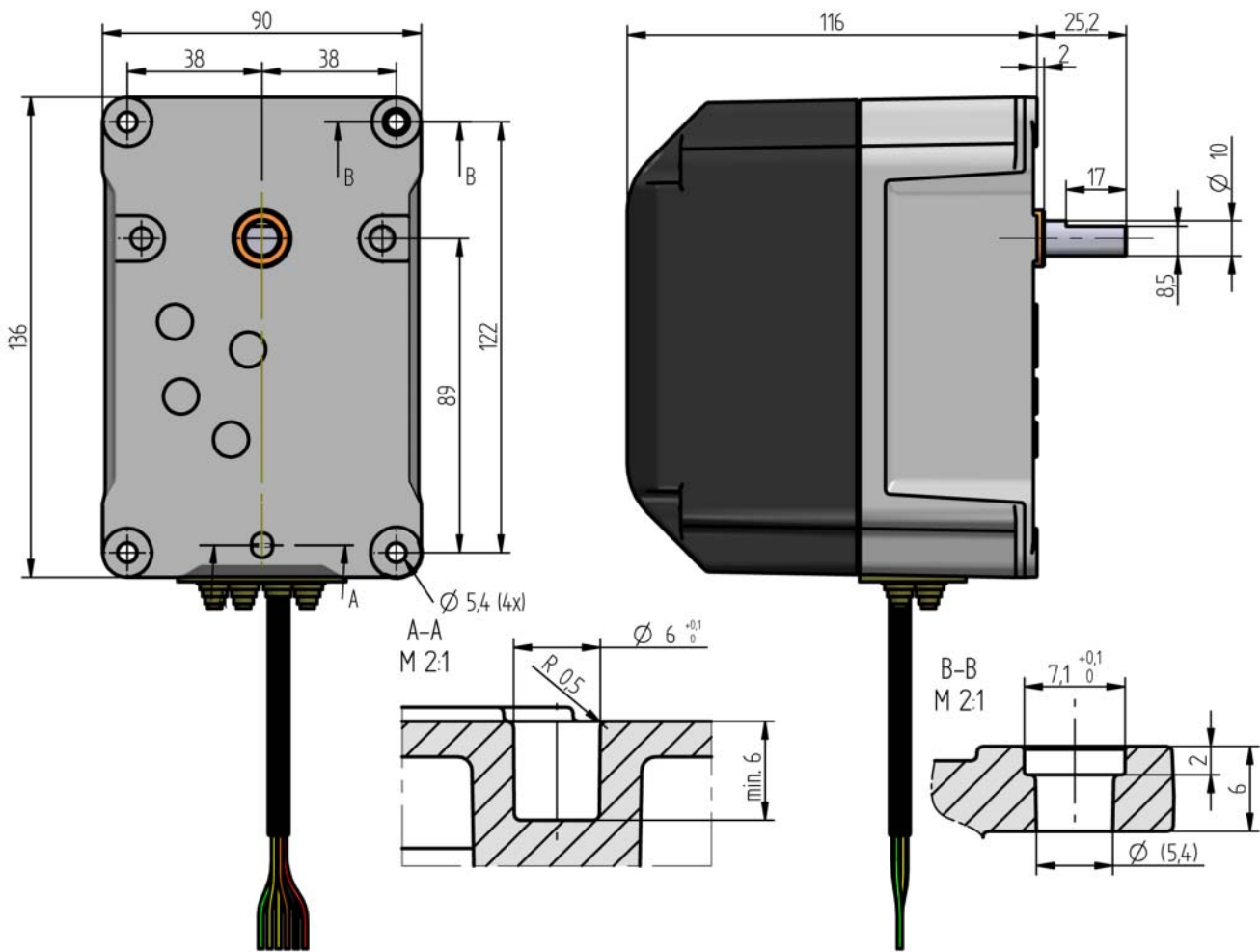

Fig. 1-2 Dimensional drawing of servo motor type 662R5001-1 and type 662R5003-1 with cable

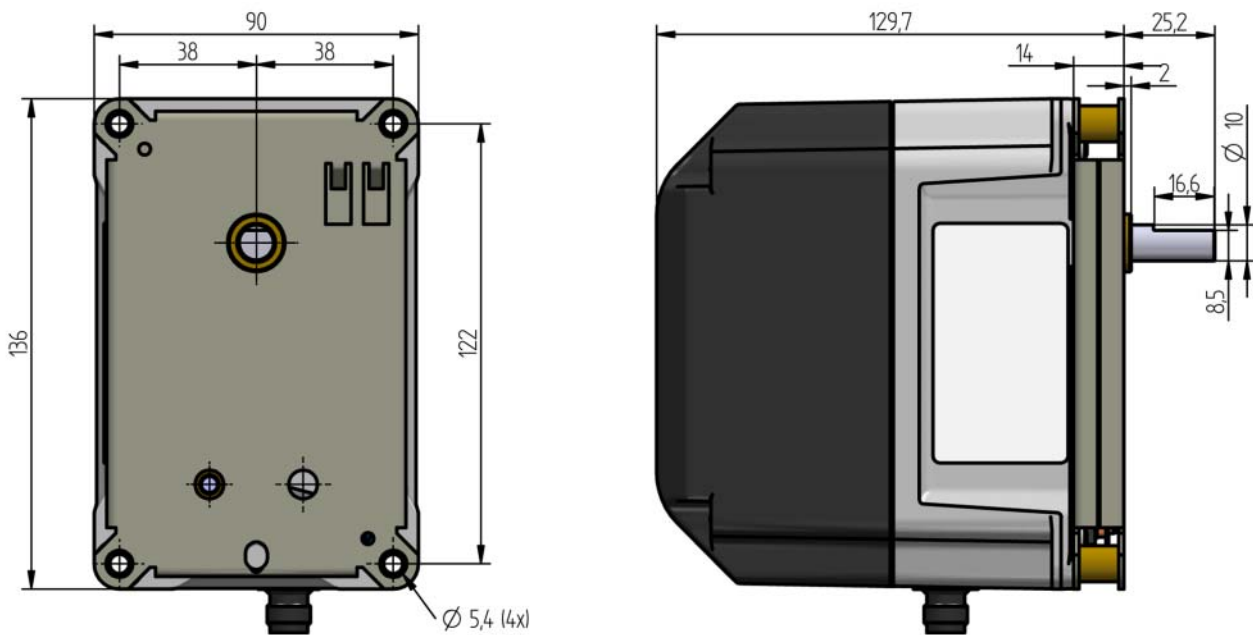

Fig. 1-3 Dimensional drawing of servo motor type 662R5009-0 without cable but with plug

## Technical Data servo motor 1,2 Nm/3 Nm/9 Nm

Function	662R5001...	662R5003...	662R5009...
Power supply	24 VDC $\pm$ 20%		
Floating time	5 s/90°	5 s/90°	15 s/90°
Direction of rotation 0° to 90°	left - view to the drive shaft		
Effective output torque	1.2 Nm (both directions of rotation)	3 Nm (both directions of rotation)	9 Nm (both directions of rotation)
Holding torque	0.82 Nm (currentless)	2.8 Nm (currentless)	6 Nm (currentless)
Permissible radial load	100 N (centre of output shaft)		
Permissible axial load	10 N		
Axial play of drive shaft	0.1 ... 0.2 mm (0.0039" x 0.0079" in)	0.1 ... 0.2 mm (0.0039" x 0.0079" in)	0.1 ... 0.2 mm (0.0039" x 0.0079" in)
Motor	RDM 51/6 stepper motor		
Angular resolution	0.1°/motor step	0.1°/motor step	0.03°/motor step
Rated resolution encoder monitoring	0,7°		
Monitoring accuracy	$\pm$ 0,5°	$\pm$ 0,5°	$\pm$ 1.3125° (corresponds 44 motor steps)
Repeat accuracy	$\pm$ 0,1°	$\pm$ 0,1°	$\pm$ 0,1°
Life cycle	2,000,000 motions forward and back performed on complete actuator range		
Degree of protection	IP54 according to DIN EN 60529-1		
Weight	1,400 g (3.09 lb)		
Cable length	securely connected 1.5 m (4.92 ft) pluggable max. 3 m (9.8 ft)	securely connected 1.5 m (4.92 ft) pluggable max. 3 m (9.8 ft)	pluggable max. 3 m (9.8 ft)

### Environmental conditions 662R5001.../662R5003.../662R5009...

<b>Operation</b>	Climatic condition	Class 3K5 according to DIN EN 60721-3
	Mechanical condition	Class 3M5 according to DIN EN 60721-3
	Temperature range	-20 ... +60 °C (-4 ... +140 °F) (condensation is prohibited)
<b>Transport</b>	Climatic condition	Class 2K3 according to DIN EN 60721-3
	Mechanical condition	Class 2M2 according to DIN EN 60721-3
	Temperature range	-20 ... +70 °C (-4 ... +158 °F) (condensation is prohibited)
<b>Storage</b>	Climatic condition	Class 1K3 according to DIN EN 60721-3
	Mechanical condition	Class 1M2 according to DIN EN 60721-3
	Temperature range	-20 ... +70 °C (-4 ... +158 °F) (condensation is prohibited)
<b>Bursting strength</b>	Peak voltage	4 kV
	Repeat frequency	2,5 kHz
<b>Electrical safety</b>	Protection class 2 as per DIN EN 60730	

# Technical Data servo motor 1,2 Nm/3 Nm/9 Nm

## NOTICE

**Damage of the actuator with 1.2, 3.0 and 9.0 Nm due to opening the actuators housing.**

Opening the actuator's housing will damage the actuator.  
The warranty expires.

## NOTICE

The limits of the technical data must be strictly adhered to.

## Order Information

Description / Type	Order-no.
Servo motor 1,2 Nm, class of protection IP54, angel of rotation 90°, resolution 0,1°/ step, metal transmission, with connecting plug, without connecting cable, rotation anti-clockwise	662R5001-0
Servo motor 3 Nm, class of protection IP54, angel of rotation 90°, resolution 0,1°/ step, metal transmission, with connecting plug, without connecting cable, rotation anti-clockwise	662R5003-0
Servo motor 9 Nm, class of protection IP54, angel of rotation 90°, resolution 0,1°/ step, metal transmission, with connecting plug, without connecting cable, rotation anti-clockwise, incl. spring pre-load	662R5009-0
Connecting cable for servo motor 662R5001-0, 662R5003-0, 662R5009-0, available in the following length: 150 cm (59.06" in), 300 cm (118.11" in) (please indicate the length with the order)	662R5591

Order information:

662R5001-1, 662R5003-1, 662R5009-1 incl. connecting cable 1,5 m (4.92 ft)



The information in this publication is subject to technical changes.

**LAMTEC Meß- und Regeltechnik  
für Feuerungen GmbH & Co. KG**  
Wiesenstraße 6  
D-69190 Walldorf  
Telefon: +49 (0) 6227 6052-0  
Telefax: +49 (0) 6227 6052-57

[info@lamtec.de](mailto:info@lamtec.de)  
[www.lamtec.de](http://www.lamtec.de)

